

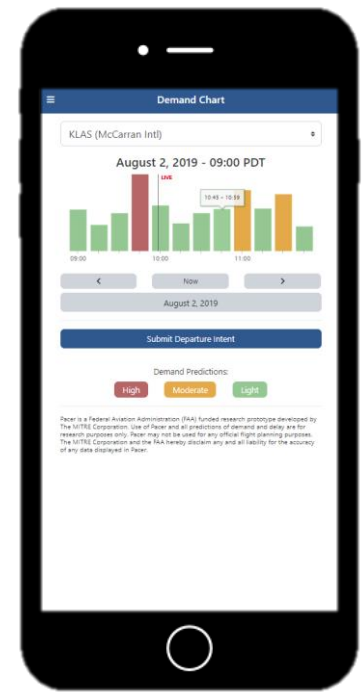

pacer User Guide

Scan QR code or visit: www.pacer.aero

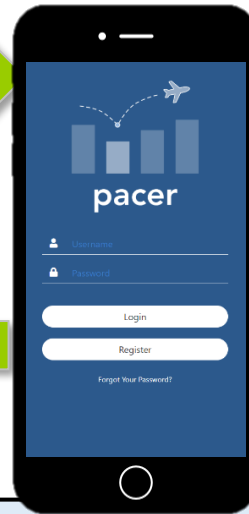

registering with pacer

1. Scan the QR code above which will take you to the Pacer web application
2. Click "Register"
3. Read the terms of agreement and fill out the fields in the registration page and click "Register"

saving pacer to your home screen:

Apple: Once on the Pacer website on Safari (www.pacer.aero), click the Share button icon (). Then select "Add to Home Screen." You will then be prompted to save or change the name. Select "Add" on the top right. An icon for the app will then be saved to your home screen.

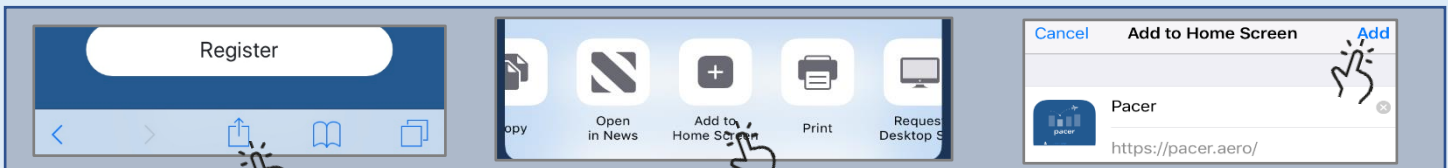

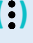
Android: After you have navigated to www.pacer.aero on your web browser, select the overflow button () from the top right corner. A menu panel will pop up. Select "Add to Home Screen" and then click "Add."

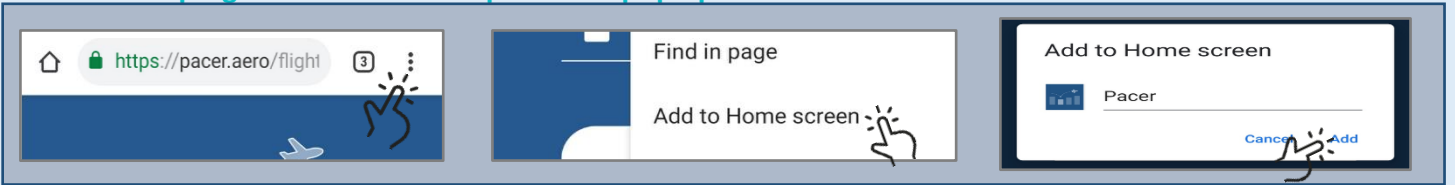

using pacer

Submit a Departure Time

- To submit a departure time, click on the blue button below the demand chart, "Submit Departure Intent." You will need to provide your callsign, origin, destination and click "Select Departure Time."
- You will then be prompted to select your intended taxi time. Demand predictions are denoted by a green, yellow, and red color coding, correlating with low, moderate, and high predicted demand. *You may select any bin, regardless of predicted demand.*

View Demand Information

- To access the demand chart, click on the menu bar in the top left corner and select "Demand Chart." This view gives you a live look at the airport you have selected.
- Click on the left or right arrows to change the timeframe being viewed.
- To toggle between days, click on the date bar below the demand chart. This will pull up a calendar and allow you to look at the future predicted demand.

Benefit of Using Pacer

Having a better awareness of busy departure times allows you to make more informed decisions and relay important information to customers as needed.